

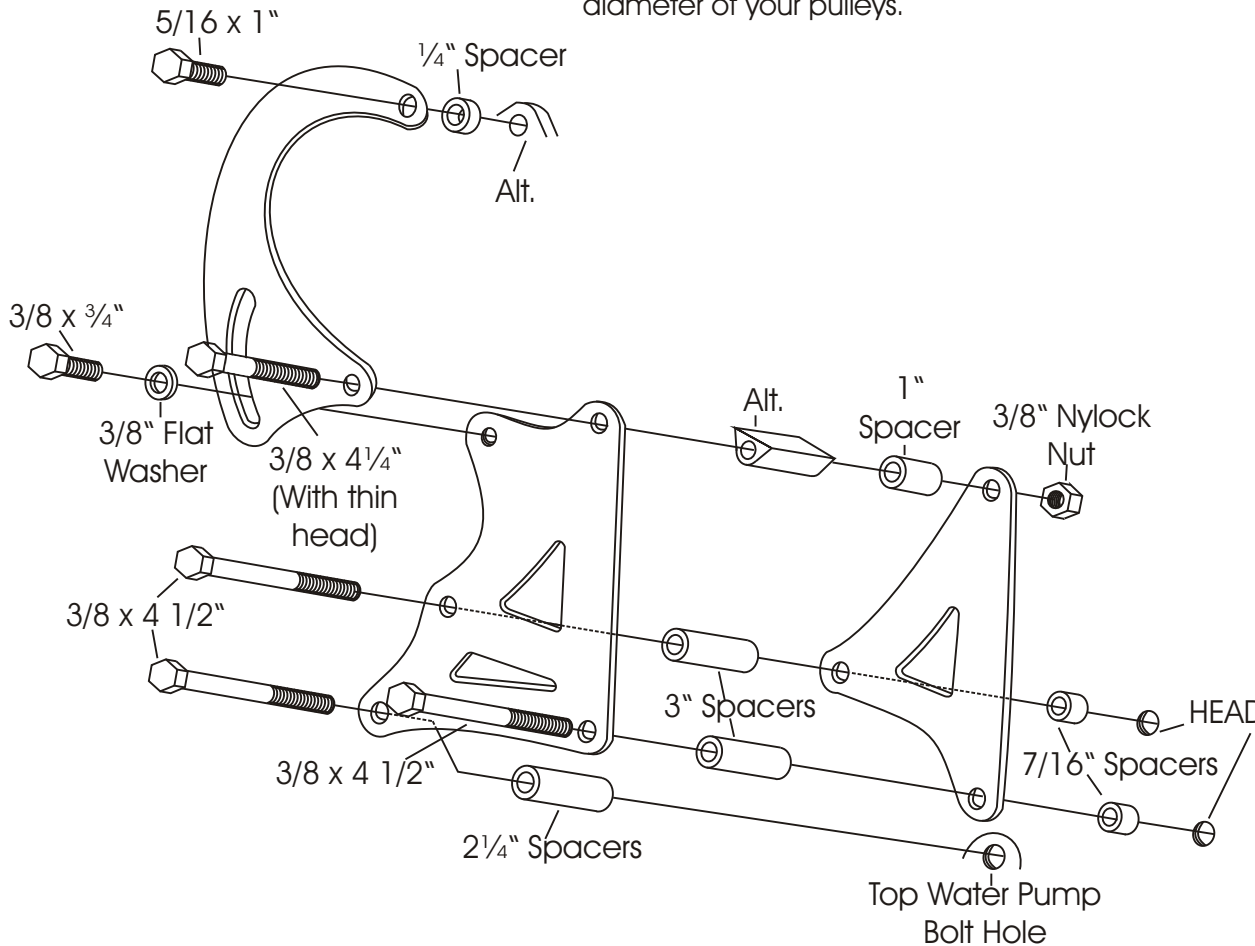

We use a belt length of 57 to 58" with this mount on installations in our shop. If using our 402L Power Steering Pump mount, Alternator belt will touch in outer groove of a two groove power steering pump pulley. Belt length for this application will be around 58 to 59". However; this can vary with the diameter of your pulleys.

# ALTERNATOR MOUNT 220L

**Small Block Chevy - Long Water Pump  
Driver's Side**



**Diagram 1**

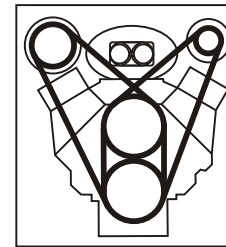

**Diagram 2**

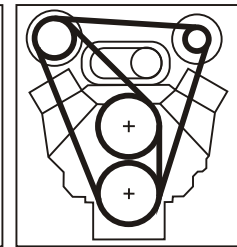

When using both A.C. and Alt. Brackets, belts can be run either of two ways - as shown. They will require the use of 2 groove crank and water pump pulleys. Routing the belts as shown in Diagram 2 - will allow clearance for small blowers and extra room for T.P.I. air cleaners. The long belt will be approximately 71-72."

**As with any part of this nature, make sure it fits your application before painting or plating. Parts that have been painted, plated, or modified may not be returned.**

ALTERNATOR  
MOUNT

220L

**Small Block Chevy - Long Water Pump  
Driver's Side**

**ALAN GROVE COMPONENTS, INC.  
27070 METCALF ROAD  
LOUISBURG, KS 66053**